



products

By K&A Manufacturing Inc.

MYRIAD KEYBOARD/MOUSE INSTALLATION INSTRUCTIONS

TOOLS REQUIRED FOR ASSEMBLY:
Cordless Drill W/ #2 Square-Recess Bit

Parts List		
ITEM	QTY	DESCRIPTION
A	1	19" or 23" Track
B	6	#10 X 3/4" Combo Drive Wood Screw
C	1	Keyboard Tray
D	1	Arm Mechanism (100F, FX, FHL, and 200FSS)
E	1	1/4-20 X 3/8" Regular Thumb Screw (Black/OX)
F	1	Mouse Tray
G	1	Track Stop (Plastic)
H	2	#10 x 1/2 Pan Phi (Black O/X)
J	2	Cord Saddle Clip
K	2	Cord "D" Clip (not shown)

GLUE STRIPS WITH GLUE DOTS

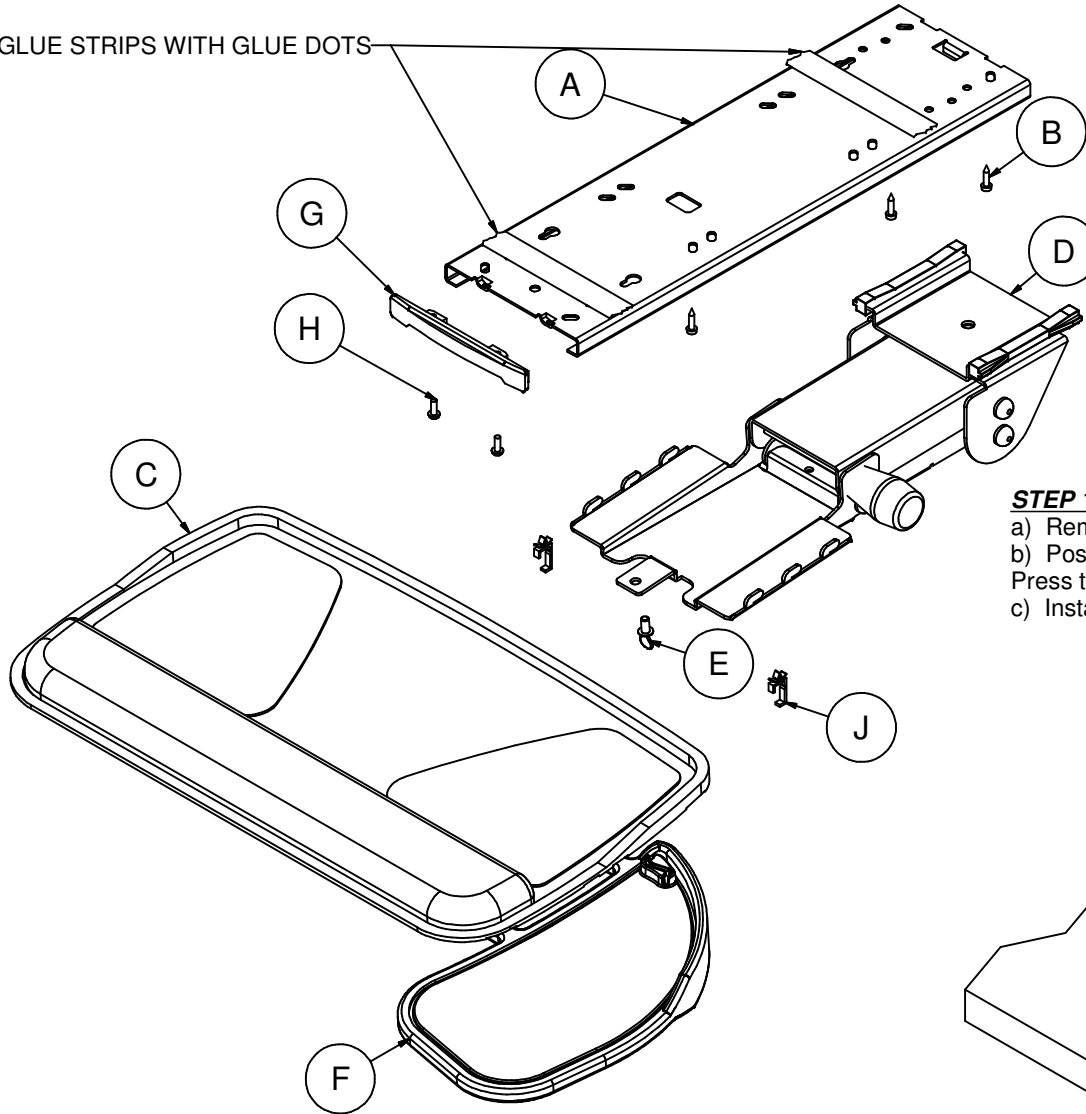

STEP 1: Mount (A) Track to bottom of worksurface as follows:
 a) Remove glue strips from track so glue dots are exposed.
 b) Position Track to be square and 1" or 1/8" setback from the front edge of the worksurface. Press track firmly into position so glue dots support the Track under the worksurface.
 c) Install (B) fasteners (six per track). Be sure not to over tighten screws.

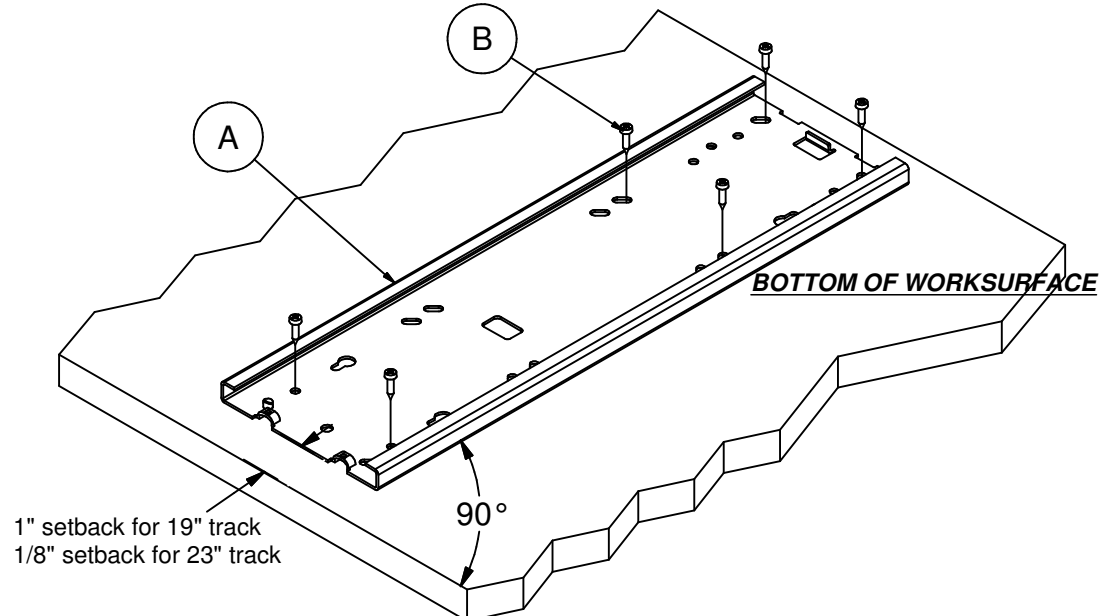

For questions or concerns, please call K & A Manufacturing, Inc. 1-800-298-4351 available Monday-Friday 8:00 AM to 5:00 PM (Central Time)

www.rightangleproducts.com

03/06/2007